

版本 REV.	日期 DATE	ECN NO.	变更内容 DESCRIPTION	制图 DRAWN

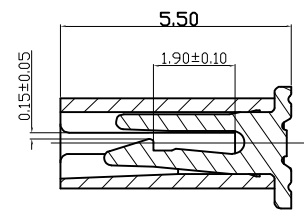

SECTION A-A

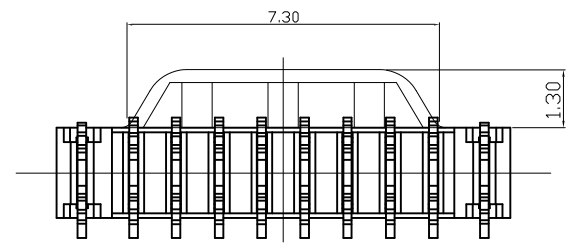
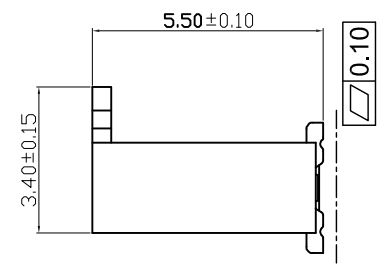
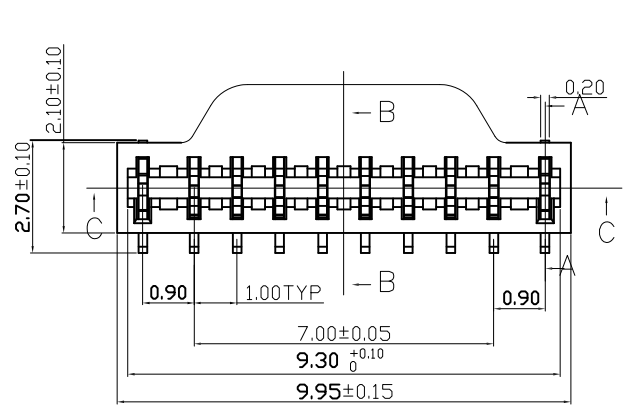
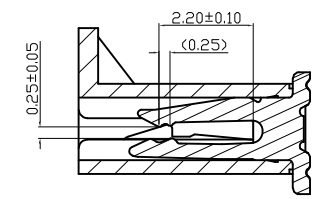

SECTION B-B

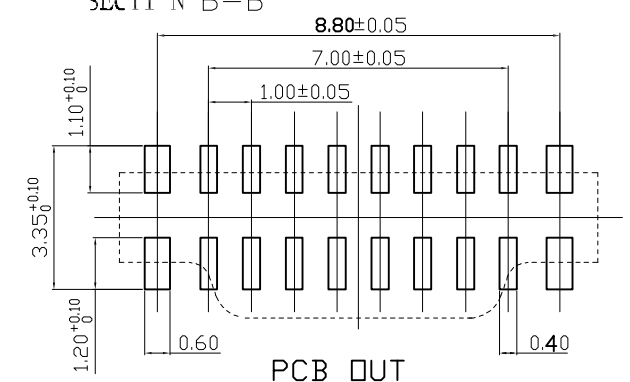
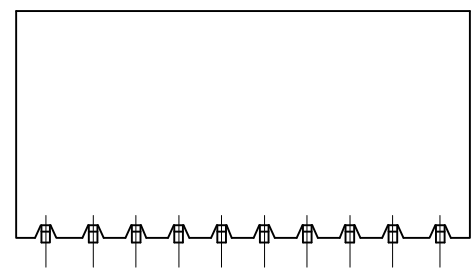

PCB OUT

SPECIFICATIONS

- Current Rating: 1A AC, DC
- Voltage Rating: 125V AC, DC
- Temperature Range: -25°C~+85°C
- Contact Resistance: 20mΩ Max
- Insulation Resistance: 100MΩ Min
- Withstanding Voltage: 500V AC/minute
- Material: Wafer LCP, UL94V-0
PIN Phosphoric copper Tin-plated
Solder tabs Phosphoric copper Tin-plated

GENERAL TOLERANCE		制图 Mapping	张迎春 2022、10、11	料号 PART NO.	B10008-10AB	版本 REV.	A
X.±0.25	X.°±2°	审核 Audit	钱岳生 2022、10、11	品名 TITLE	FPC1.0(8+2)小号 WAFER SMT TYPE	页次 SHEET	1/1
.X±0.25	.X°±1°	核准 Approved	张名 2022、10、12	客户料号 CUTM. NO.			
.XX±0.15	.XX°±0.5°	单位 Units	mm	比例 SCALE			
.XXX±0.10	.XXX°±0.5°			乐清市宏一电子有限公司 Yueqing HongYi Electronics Co., Ltd			